

1.5 Pneumatic-hydraulic cylinders

1.5.1 Attachment 53 With front thread \varnothing 32-100 mm double-acting

Technical features

Function	Double-acting	63= G3/8",
Design	Compact round cylinder, front and end pieces bolted to cylinder, therefore these cylinders are repairable.	80= G3/8", 100= G1/2"
We keep sets of seals for you in store.		Any fitting position
Materials	Piston rod: stainless steel; cylinder: hard-coated aluminium; front and end pieces: aluminium	Temperature -20°C to +80°C
		Medium Filtered, oil-bearing or oil-free compressed air and hydraulic oils
		Freely selectable action
		Operating pressure 1 to 10 bar

Pistons \varnothing 32, 40, 50, 63, 80, 100 mm
Connections 32= G1/8", 40 / 50= G1/4",

Customized solutions on request

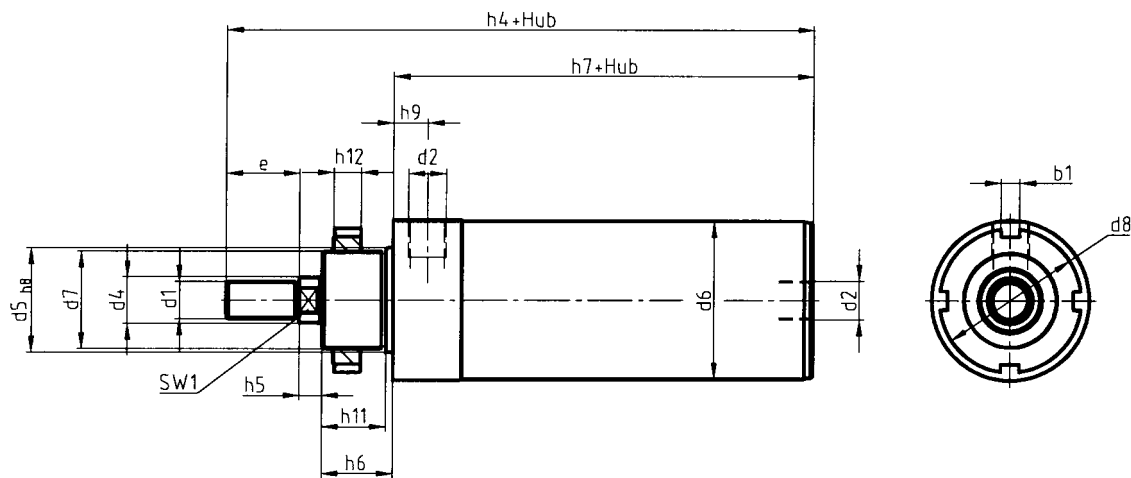

Piston \varnothing	b_1	d_1	d_2	d_4 \varnothing	d_5 \varnothing h8	d_6 \varnothing	d_7 \varnothing	d_8 \varnothing	h_4	h_5	h_6	h_7	h_9	h_{11}	h_{12}	e	WF ₁
32	6	M10	G1/8	12	32	38	M30x1.5	42	116	8	20	68	10	18	8	20	10
40	7	M12	G1/4	16	40	45	M38x1.5	50	127	9	23	71	11	20	10	24	13
50	8	M16x1.5	G1/4	20	45	55	M42x1.5	62	150	10	31	77	11	28	12	32	17
63	8	M16x1.5	G3/8	20	45	68	M42x1.5	62	161	10	31	88	15	28	12	32	17
80	10	M20x1.5	G3/8	25	60	86	M58x1.5	90	197	10	40	107	15	36	13	40	21
100	10	M20x1.5	G1/2	25	60	107	M58x1.5	90	206	10	45	111	17	40	13	40	21

Fitting punch >Window-making industry<

Pneumatic-hydraulic drive with integrated booster and fitted punching tool.
30,000 N compressive force at 6 bar

⇒ Punching of fittings for the window-making industry



Hydraulic cylinder unit >Electrical engineering industry<

Compact pneumatic-hydraulic booster with attachment flange
15,000 N compressive force at 6 bar

Crimping crimp connectors and cable line

